

I MINA'TRENTAI SAIS NA LIHESLATURAN GUÅHAN
2021 (FIRST) Regular Session
VOTING RECORD

NAME	Aye	Nay	Not Voting/ Abstained	Out During Roll Call	Absent	Excused
Senator V. Anthony Ada	✓					
Senator Frank Blas Jr.	✓					
Senator Joanne Brown	✓					
Senator Christopher M. Dueñas	✓					
Senator James C. Moylan	✓					
Vice Speaker Tina Rose Muña Barnes					✓	✓
Senator Telena Cruz Nelson	✓					
Senator Sabina Flores Perez	✓					
Senator Clynton E. Ridgell	✓					
Senator Joe S. San Agustin	✓					
Senator Amanda L. Shelton	✓					
Senator Telo T. Taitague	✓					
Senator Jose "Pedro" Terlaje					✓	✓
Speaker Therese M. Terlaje	✓					
Senator Mary Camacho Torres	✓					

TOTAL

13
Aye

0
Nay

**Not
Voting/
Abstained**

**Out
During
Roll Call**

2
Absent

2
Excused

CERTIFIED TRUE AND CORRECT:

 RENNAE V. C. MENG
 Clerk of the Legislature

I = Pass

Speaker Antonio R. Unpingco Legislative Session Hall
 Guam Congress Building
 December 15, 2021

I MINA'TRENTAI SAIS NA LIHESLATURAN GUÅHAN
2021 (FIRST) Regular Session

Bill No. 210-36 (COR)

As amended by the Committee on Public Safety,
Emergency Response, Military and Veterans
Affairs, Mayors' Council, and Public Transit;
and further amended on the Floor.

*

Introduced by:

Joe S. San Agustin
Telena Cruz Nelson
Joanne Brown
Telo T. Taitague
Christopher M. Dueñas
V. Anthony Ada
Frank Blas Jr.
James C. Moylan
Tina Rose Muña Barnes
Sabina Flores Perez
Clynton E. Ridgell
Amanda L. Shelton
Jose "Pedo" Terlaje
Therese M. Terlaje
Mary Camacho Torres

**AN ACT RELATIVE TO APPROVING THE PLANS FOR
THE GUAM PACIFIC ISLAND GOLD STAR FAMILIES
MEMORIAL MONUMENT.**

1 **BE IT ENACTED BY THE PEOPLE OF GUAM:**

2 **Section 1. Legislative Findings and Intent.** *I Liheslaturan Guåhan* finds
3 that the Guam Pacific Island Gold Star Families Memorial Monument (Memorial
4 Monument) is authorized to be established at the Skinner Plaza in the municipality
5 of *Hagåtña*, through Public Law 36-55, and *I Liheslatura* has received the official

1 plans for the Memorial Monument from the Gold Star Families Memorial
2 Monument Planning Committee.

3 Therefore, it is the intent of *I Liheslaturan Guåhan* to approve the plans for
4 the Memorial Monument at the Skinner Plaza in honor of Guam’s Gold Star Service
5 members’ families.

6 **Section 2. Approval of the Plans for the Guam Pacific Island Gold Star**
7 **Families Memorial Monument.** Pursuant to 21 GCA § 79606, *I Liheslaturan*
8 *Guåhan* hereby accepts and approves the plans for the Guam Pacific Island Gold
9 Star Families Memorial Monument as depicted and attached hereto as “Exhibit A.”

10 **Section 3. Severability.** If any provision of this Act or its application to
11 any person or circumstance is found to be invalid or contrary to law, such invalidity
12 shall not affect other provisions or applications of this Act that can be given effect
13 without the invalid provision or application, and to this end the provisions of this
14 Act are severable.

15 **Section 4. Effective Date.** This Act shall be effective upon enactment.

"EXHIBIT A"

GRANITE MONUMENT W/
CONCRETE WALK, BASE &
FOUNDATION

20'-0"

10'-0"

SIDEWALK -
VERIFY
EXISTING
CONDITIONS

SUGGESTED
ORIENTATION

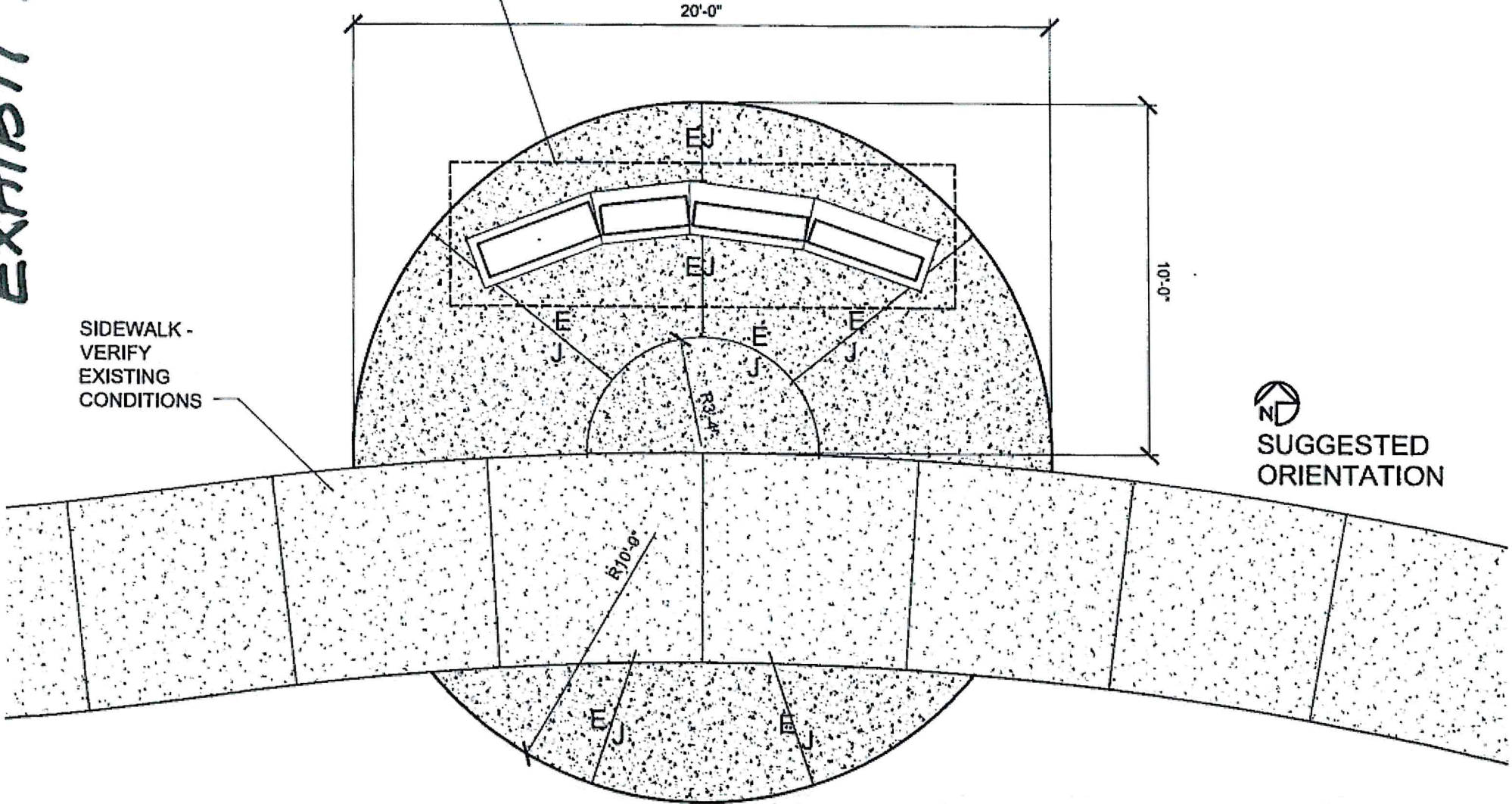

© 2014 Blackwood Associates, Inc.

GOLD STAR FAMILIES MEMORIAL MONUMENT
HERSHEL "WOODY" WILLIAMS MEDAL OF HONOR FOUNDATION
WWW.HVWMOHFOUNDATION.ORG



blackwood associates inc.
www.wvarchitects.com



Johnny K. Aquino 10-4-21

PLAN



①

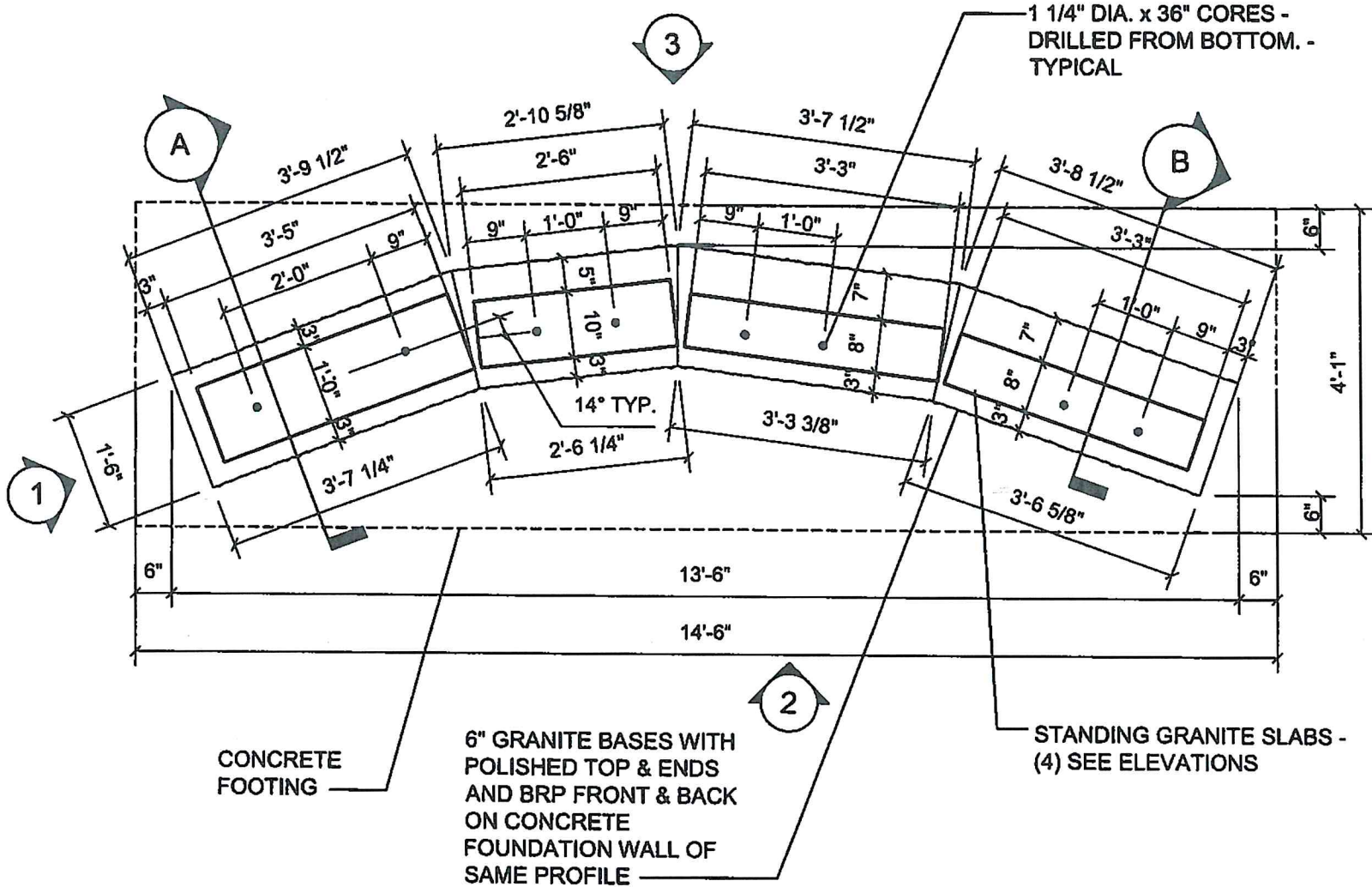

© 2014 Blackwood Associates, Inc.

GOLD STAR FAMILIES MEMORIAL MONUMENT
HERSHEL "WOODY" WILLIAMS MEDAL OF HONOR FOUNDATION
 WWW.HWWWMOHFOUNDATION.ORG

blackwood associates inc.
 www.vvarchitects.com



10-4-21

ENLARGED PLAN

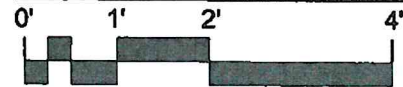

②

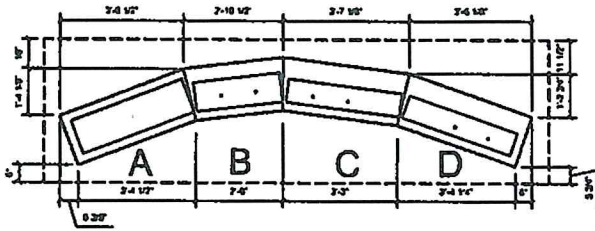

○ KEY PLAN
NTS

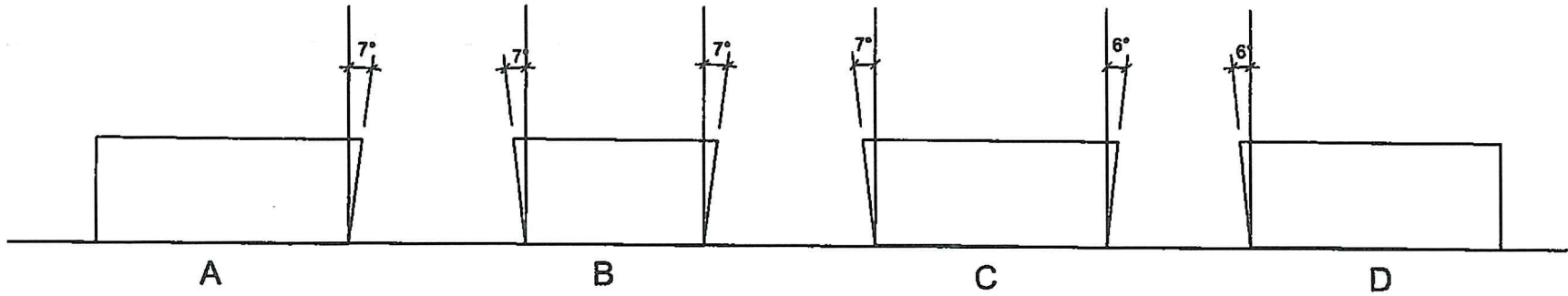

© 2014 Blackwood Associates, Inc.

GOLD STAR FAMILIES MEMORIAL MONUMENT
HERSHEL "WOODY" WILLIAMS MEDAL OF HONOR FOUNDATION
WWW.HWMMOHFOUNDATION.ORG

 **blackwood associates inc.**
www.vvarchitects.com



 10-4-21

SUPPLEMENTAL BASE INFO

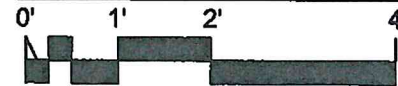

2A

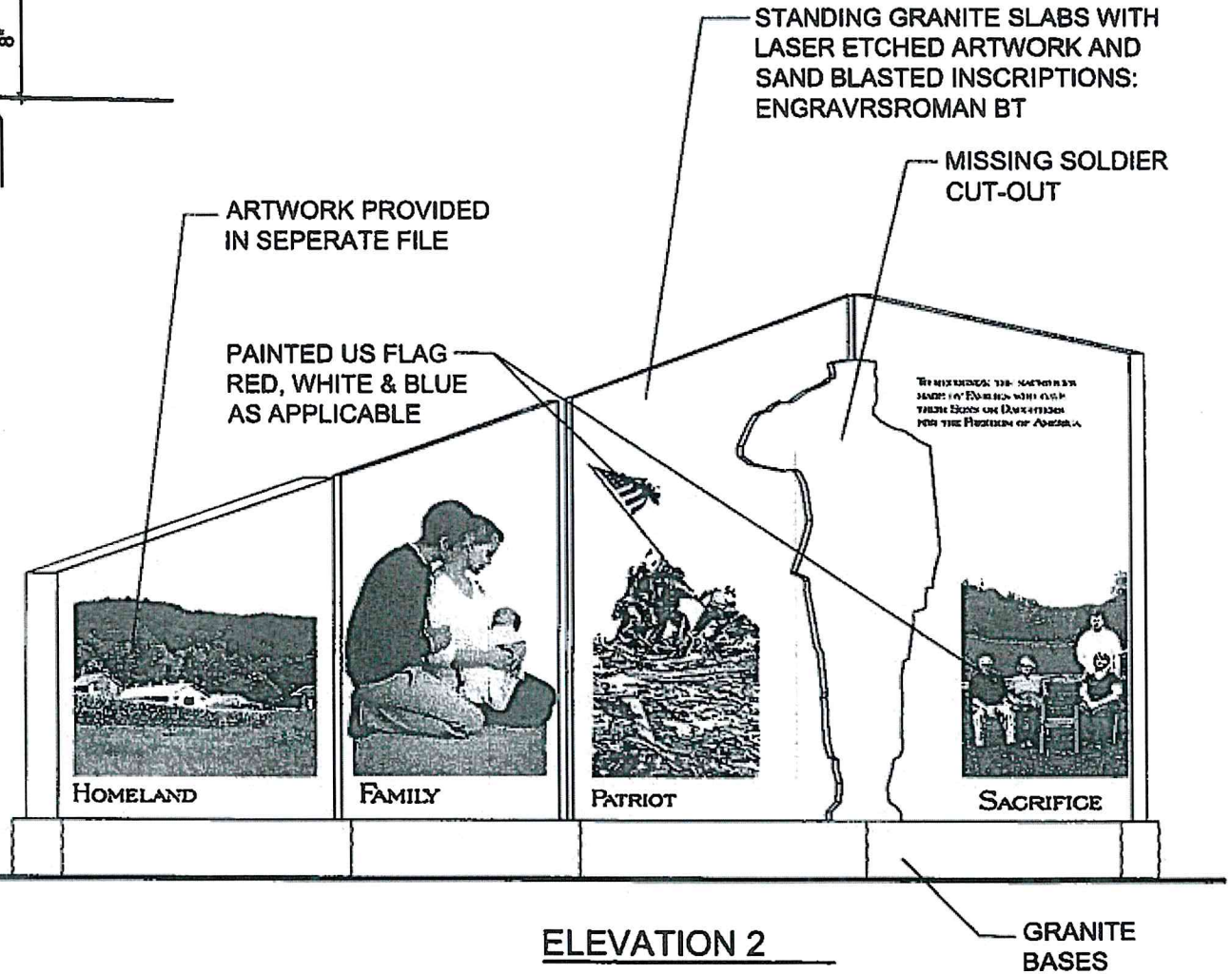
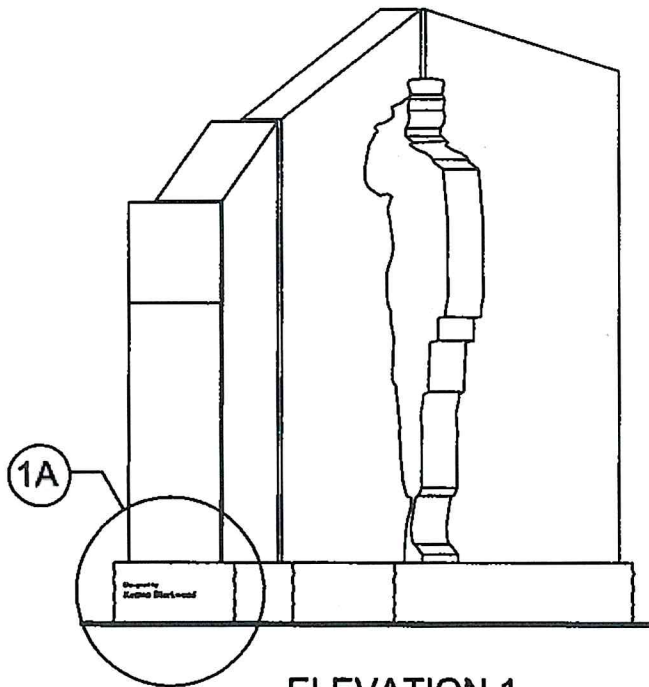
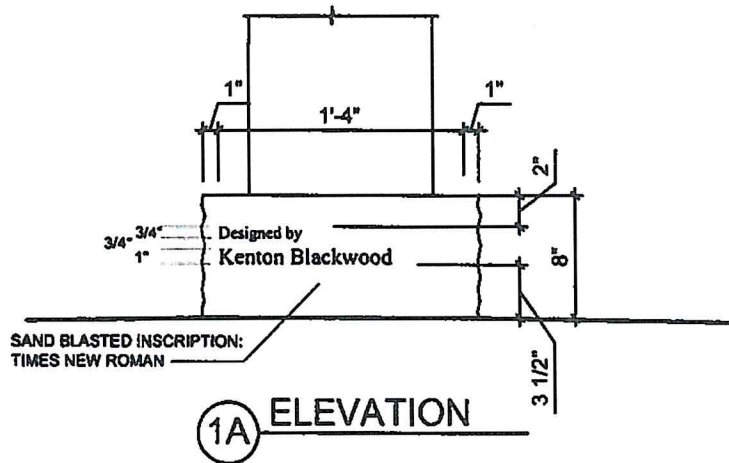

GOLD STAR FAMILIES MEMORIAL MONUMENT
HERSHEL "WOODY" WILLIAMS MEDAL OF HONOR FOUNDATION
 WWW.HWWMOHFOUNDATION.ORG

blackwood associates inc.
 www.wvarchitects.com



10-4-21

ELEVATIONS

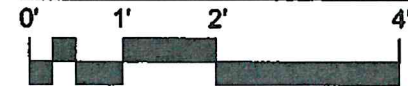

3

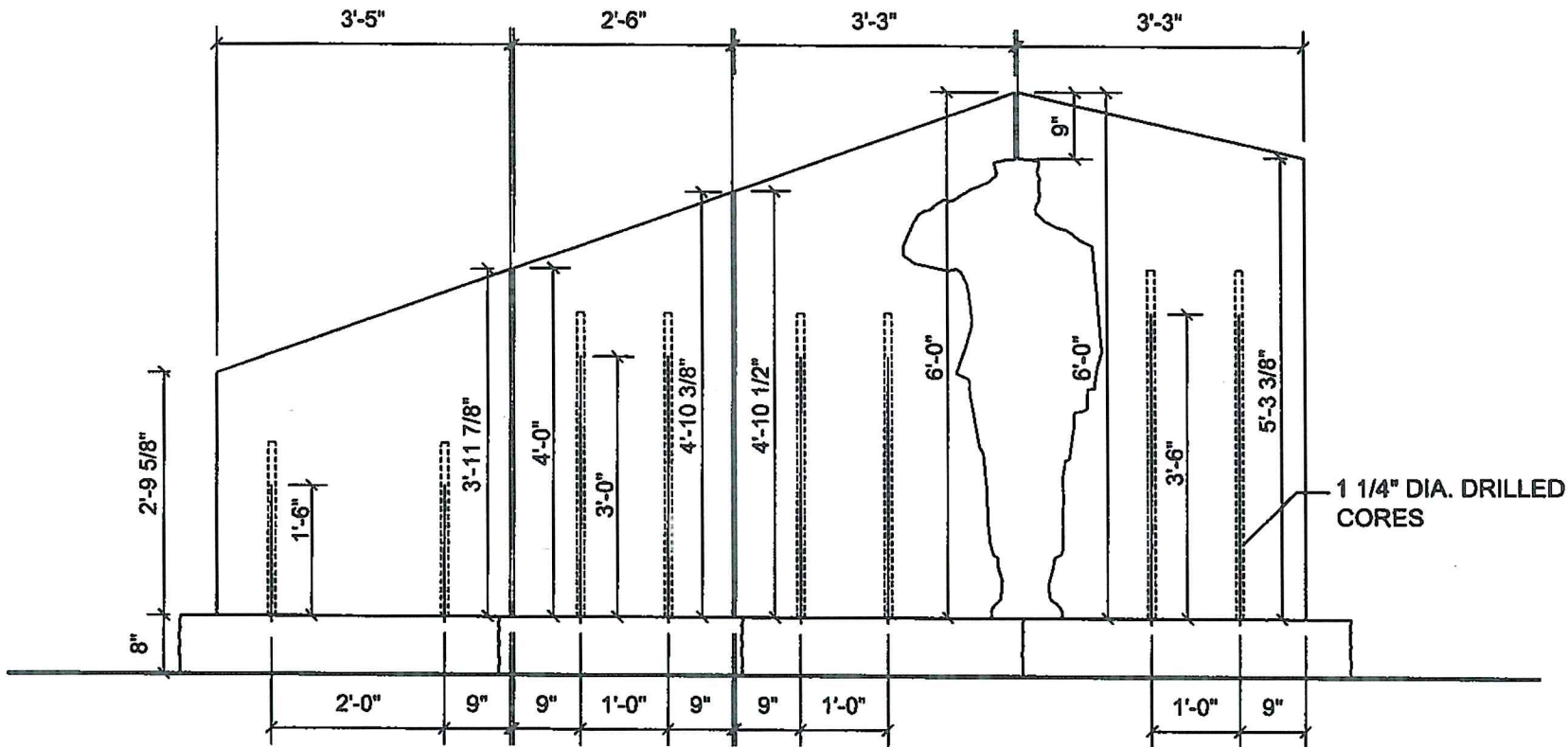

ELEVATION 2

GOLD STAR FAMILIES MEMORIAL MONUMENT

HERSHEL "WOODY" WILLIAMS MEDAL OF HONOR FOUNDATION

WWW.HWWMOHFOUNDATION.ORG



blackwood associates inc.
www.wvarchitects.com



[Signature] 10-4-21

ELEVATION

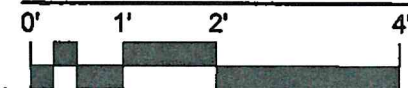

CAST BRONZE NAUTICAL STAR AND LETTERING
 (TIMES NEW ROMAN) WITH CONCEALED
 STAINLESS STEEL FASTENERS

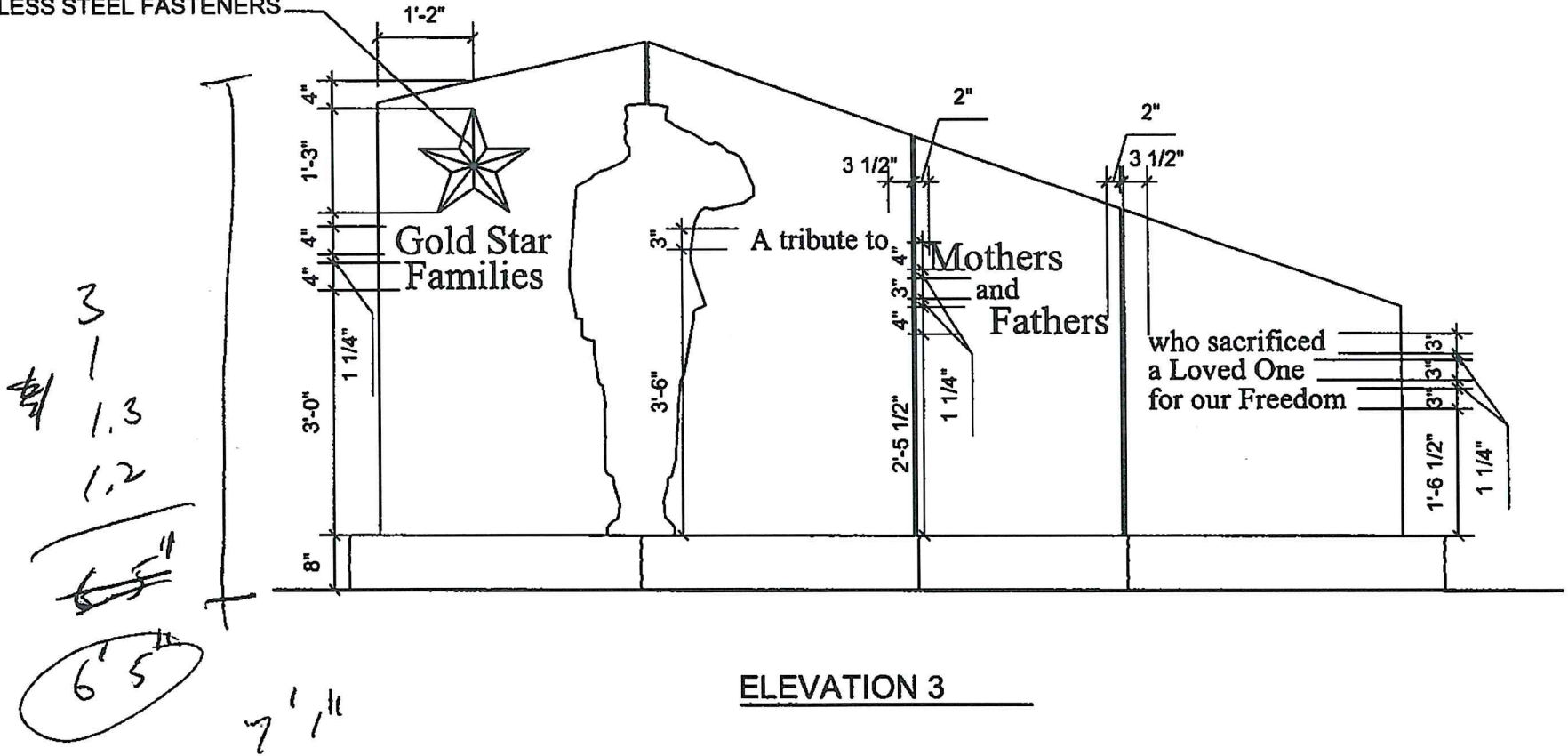

ELEVATION 3

GOLD STAR FAMILIES MEMORIAL MONUMENT
 HERSHEL "WOODY" WILLIAMS MEDAL OF HONOR FOUNDATION
 WWW.HWWWOMHFOUNDATION.ORG

 **blackwood associates inc.**
 www.wvarchitects.com



 10-4-21

ELEVATION



⑤

KEY NOTES

1. 8" STANDING GRANITE SLAB, ALL POLISHED, ANGLED TOP, WITH SOLDIER CUT-OUT
2. 12" STANDING GRANITE SLAB, ALL POLISHED, WITH ANGLED TOP
3. 8" GRANITE BASE, POLISHED TOP AND ENDS, BRP FRONT AND BACK EDGES
4. REINFORCED CONCRETE FOUNDATION (4000 PSI) WITH DEAD FLAT TOP SURFACE, SMOOTH AND CLEAN TO ACCEPT GRANITE. (FOUNDATIONS ARE DESIGNED WITH AN ASSUMED MAXIMUM ALLOWABLE SOIL BEARING PRESSURE OF 2000 PSF NET. PROVIDE #4 REBARS CONTINUOUS AND @ 12" O.C. - TYPICAL PRIOR TO CONCRETE PLACEMENT, THE BEARING CAPACITY OF THE SOIL SHALL BE INSPECTED & APPROVED BY THE PROJECT GEOTECHNICAL ENGINEER.)
5. 4" CONCRETE SIDEWALK (4000 PSI) WITH LIGHT BROOM FINISH OVER 6 MIL VAPOR BARRIER ON #57 STONE BASE OVER GEO-TEXTILE STABILIZATION FABRIC AND COMPACTED SUBGRADE, 6X6 - W2.1XW2.1 WWF, CUT TO FIT ALONG RADIAL EDGE (TYP.) - MESH MUST BE HELD UP W/ CHAIRS. HOLD WWF 2" FROM TOP. SLOPE AWAY FROM MONUMENT.
6. 1 1/4" DIA. DRILLED CORES
7. #7 BARS AT FOUNDATION THRU DRILLED CORES.
8. 1/2" EXPANSION JOINT - BOND BREAKER MATERIAL W/ CAULK, CONTINUOUS, COLORED TO MATCH CONCRETE - TYPICAL AT EACH SIDE.

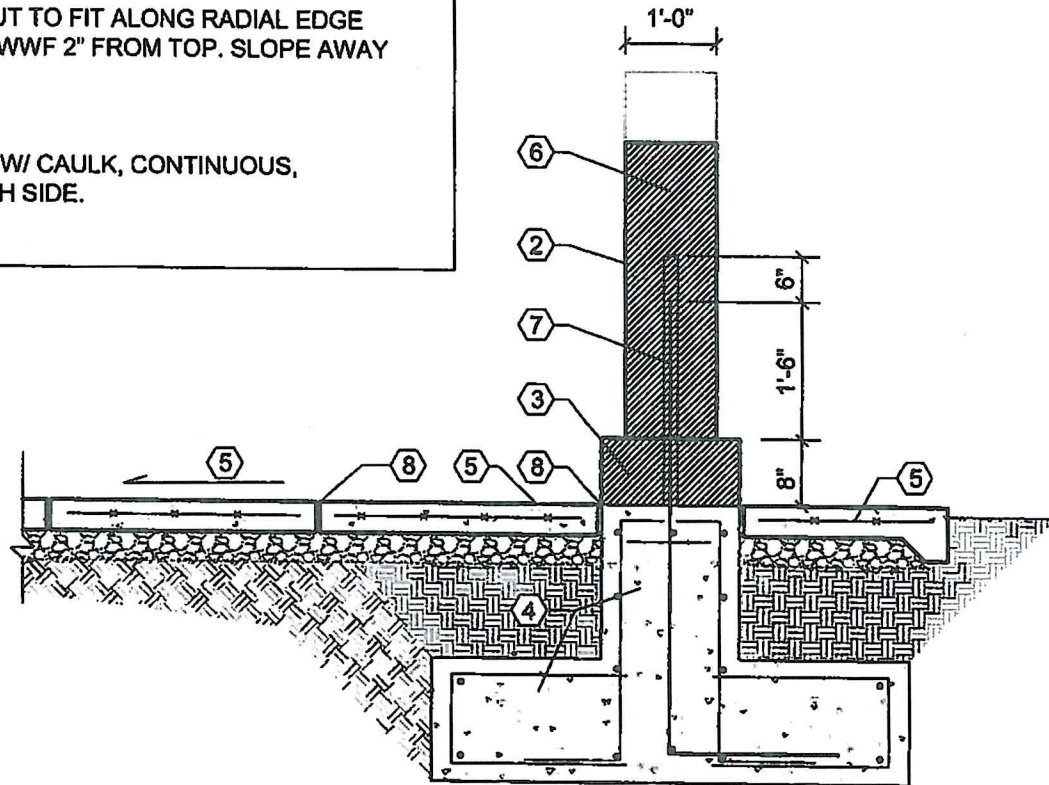

GOLD STAR FAMILIES MEMORIAL MONUMENT

HERSHEL "WOODY" WILLIAMS MEDAL OF HONOR FOUNDATION

WWW.HWWWMOHFOUNDATION.ORG



blackwood associates inc.
www.wvarchitects.com



10-4-21

SECTION A

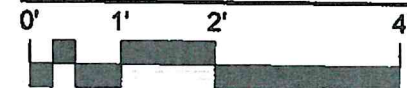

⑥

KEY NOTES

1. 8" STANDING GRANITE SLAB, ALL POLISHED, ANGLED TOP, WITH SOLDIER CUT-OUT
2. 12" STANDING GRANITE SLAB, ALL POLISHED, WITH ANGLED TOP
3. 8" GRANITE BASE, POLISHED TOP AND ENDS, BRP FRONT AND BACK EDGES
4. REINFORCED CONCRETE FOUNDATION (4000 PSI) WITH DEAD FLAT TOP SURFACE, SMOOTH AND CLEAN TO ACCEPT GRANITE. (FOUNDATIONS ARE DESIGNED WITH AN ASSUMED MAXIMUM ALLOWABLE SOIL BEARING PRESSURE OF 2000 PSF NET. PROVIDE #4 REBARS CONTINUOUS AND @ 12" O.C. - TYPICAL PRIOR TO CONCRETE PLACEMENT, THE BEARING CAPACITY OF THE SOIL SHALL BE INSPECTED & APPROVED BY THE PROJECT GEOTECHNICAL ENGINEER.)
5. 4" CONCRETE SIDEWALK (4000 PSI) WITH LIGHT BROOM FINISH OVER 6 MIL VAPOR BARRIER ON #57 STONE BASE OVER GEO-TEXTILE STABILIZATION FABRIC AND COMPACTED SUBGRADE, 6X6 - W2.1XW2.1 WWF, CUT TO FIT ALONG RADIAL EDGE (TYP.) - MESH MUST BE HELD UP W/ CHAIRS. HOLD WWF 2" FROM TOP. SLOPE AWAY FROM MONUMENT.
6. 1 1/4" DIA. DRILLED CORES
7. #7 BARS AT FOUNDATION THRU DRILLED CORES.
8. 1/2" EXPANSION JOINT - BOND BREAKER MATERIAL W/ CAULK, CONTINUOUS, COLORED TO MATCH CONCRETE - TYPICAL AT EACH SIDE.

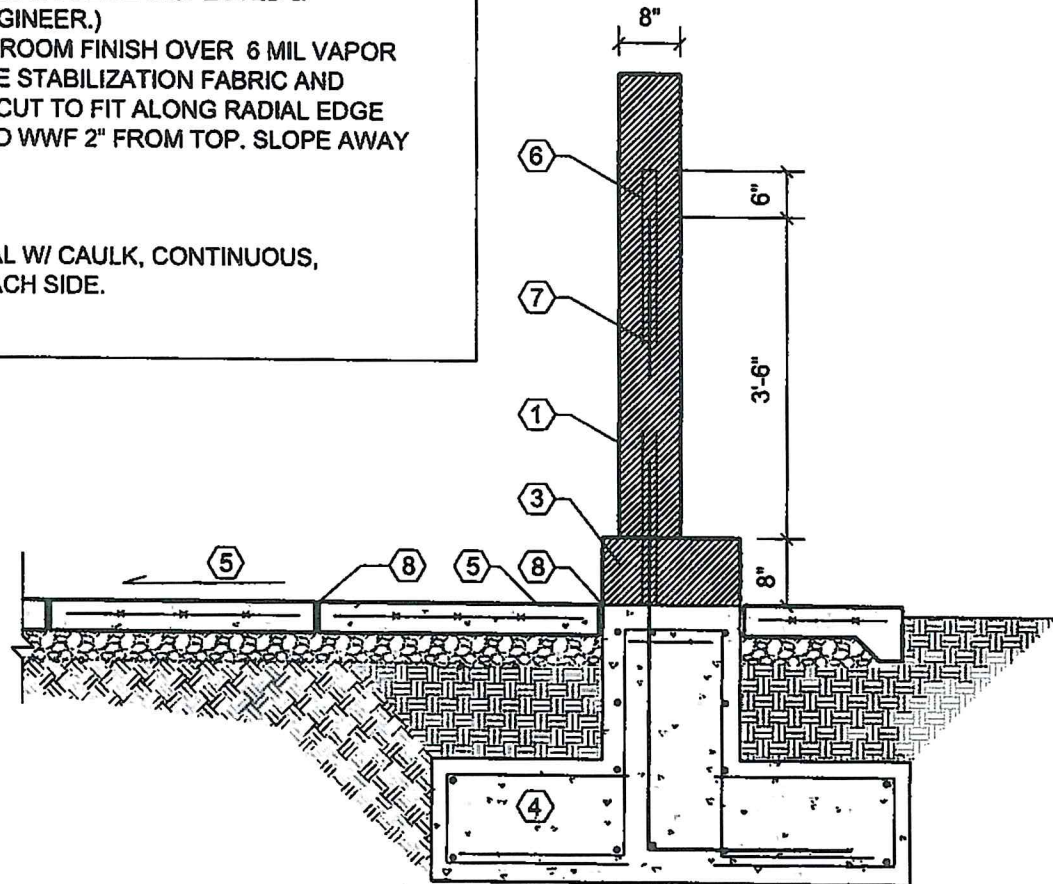

GOLD STAR FAMILIES MEMORIAL MONUMENT
HERSEL "WOODY" WILLIAMS MEDAL OF HONOR FOUNDATION
WWW.HVWMOHFOUNDATION.ORG

 **blackwood associates inc.**
www.wvarchitects.com



SECTION B

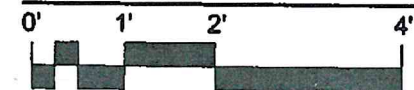

⑦

10-4-21